

- The customer has to make alternative arrangements for the patient by himself during the time required to repair the unit.
- The warranty ceases if the product is used on a different voltage (may be outside India) with or without using a converter to change the voltage. Example using in US at 110 volts
- Replacement or repair under warranty period does not give rise to extension or renewal of warranty period

**Limitation of Warranty:**  
The liability of the manufacturer is limited to the selling cost of the product at first point, in no event the manufacturer will be liable for indirect, special or consequential damages to the patients of the user

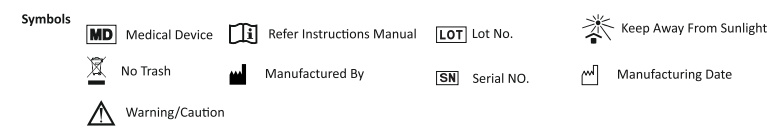

Manufactured by:  
**Passim Medicchem Agencies**  
At Plot No. 32, 2<sup>nd</sup> Floor, Sector -5,  
IMT Manesar, Gurugram,  
Haryana-122050 (India)  
Loan Licence No.:  
MFG/MD/2022/000150  
Marketed By:  
**Passim Medicchem Agencies**  
# 186, Ind. Area Phase II,  
Chandigarh 160 002  
**Corporate Office:**  
# 902, 9<sup>th</sup> Floor, WallFort House,  
S.V. Road, Near Citi Mall,  
Goregaon (W), Mumbai-400 062  
**For Any Complaint/ Suggestion**  
**Please Contact :**  
Tel. No.:1800 309 3009  
(Timing: 9am -7pm, Mon. - Sat.)  
Email ID: customercare@drodin.in  
Website: www.drodin.in

To Know More About Us  
Scan QR Code



7

# Dr. Odin®

## Compressor Nebulizer

### User Manual

#### OD-305



- Storage Cautions:**
- Do not store the unit under direct sunlight, high temperature or humidity
  - Keep the unit out of reach of small children.
  - Always keep the unit unplugged while not in use.

**Operating Cautions:**

- Connect this product to an appropriate voltage outlet for your model.
- Do not run the product unattended.
- Never operate if this unit has a damaged cord or plug, if it has been dropped, or in any way, submerged into water if it does not work properly. Return it to a service center for repair.
- If any abnormality occurs, discontinue use immediately until the unit has been examined and repaired.
- Always unplug the product immediately after use.
- Never block the air opening of the main unit or place it where the air openings may be obstructed.

**Cleaning Cautions:**

- Do not immerse the unit in water, it may damage the unit.
- Disconnect the unit from the electrical outlet before cleaning.
- Clean all necessary parts after each use as instructed in this guidebook.

**4. OPERATING YOUR COMPRESSOR NEBULIZER**  
**WARNING**

- Clean and disinfect the nebulizer kit, mouthpiece, and optional nosepiece or masks before using them for the first time after purchase.
- If the device has not been used for a long period of time clean and disinfect the nebulizer kit, mouthpiece, and optional nosepiece or masks before using them.

**CAUTION**

- Make sure the air filter is clean. If the air filter has changed color replace the filter.
- DO not loose the inner cone in the nebulizer Bottle or it will stop making fumes  
The compressor motor has a thermal protector, which will shut off the unit before the unit is overheated. When the thermal protector shuts the unit off, please switch off the unit.

**How to use**

- Place your Compressor Nebulizer on a flat and stable surface. Be sure that you can easily reach the controls when you are seated.
- Gently twist the top part of nebulizer Bottle - clockwise to disassemble the nebulizer.

3

- Fill the bottom section of the nebulizer with the medication prescribed by your physician. Be sure that the cone is put inside the bottom section.
- Gently twist the top part clockwise to reassemble the nebulizer. Be sure the two sections fit well.
- Attach one end of air tube to the base of the nebulizer.
- Attach the other end of air tube to the tube connector located on the front of the compressor.
- Attach mouthpiece or mask per your choice to the top section of nebulizer.
- Plug the power cord into an appropriate electrical outlet. Make sure at this stage, the power switch is at "OFF" status. 9. Press power switch to begin your prescribed treatment.
- Unplug the unit from the electrical outlet
- Wait for 30 minutes for the motor to cool down before another treatment. make sure the air opening are not obstructed
- When treatment is finished, shut off the unit and unplug it from the electrical outlet.

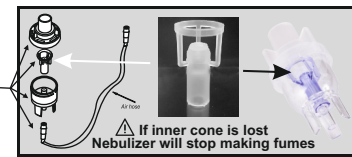

**5. CLEANING**

It is recommended that the nebulizer, mouthpiece and mask be thoroughly cleaned with warm water after each use and cleaned with a mild detergent after the last treatment of the day. If your physician or respiratory therapist specifies a different cleaning procedure, follow their instructions. (Do not use Boiling water to clean the nebulizer's accessories as it may effect the working)

**Rinsing (after each treatment)**

- Disconnect the air tube, nebulizer, mouthpiece and mask.
- Gently twist the nebulizer to open it.
- Rinse the nebulizer, mouthpiece and mask with water.
- Dry them with clean soft towel or let it air dry.
- Reassemble the nebulizer when completely dry and put these parts in a dry, sealed container.

**Disinfections:**

Please follow the following steps to disinfect your nebulizer unless otherwise specified by your physician. It is suggested that the unit is disinfected after the last treatment of the day.

- Use one part white vinegar with three parts distilled water. Make sure mixed solution is enough to submerge the nebulizer, mouthpiece, and mask.
- Complete Rinsing Steps 1-3. (Mentioned above)
- Wash nebulizer, mouthpiece and mask in warm water and a mild detergent. Then wash them in hot tap water.
- Submerge these parts in the vinegar and water solution for thirty minutes.

4

## COMPRESSOR NEBULIZER

### INSTRUCTION

**INDEX**

- Introduction .....Page 1
- Product Identification .....Page 2
- Important Safeguards .....Page 2
- Operating Your Compressor Nebulizer .....Page 3
- Cleaning .....Page 4
- Replacement Parts & Optional Accessories .....Page 5
- Specifications .....Page 5

**1. INTRODUCTION**

Thank you for purchasing the compressor nebulizer. It is a compact medical device designed to efficiently deliver physician prescribed medication to the bronchial lung passage. With proper care and use, it will provide you with many year of reliable treatment.

This product is developed for the successful treatment of asthma, allergies and other respiratory disorders. It creates a stream of air that travels through clear tube to the nebulizer. When air enters the nebulizer, it will convert the prescribed medication into aerosol mist for easy inhalation.

Your compressor nebulizer should be used under the supervision of a licensed physician and/ or a respiratory therapist. We encourage you to thoroughly read this guidebook to learn about the features of this product. Any use of this product other than its intended use should always be avoided.

1

**5. Complete Rinsing Steps 3-5. (Mentioned above)**

**Cleaning the compressor**

- Wipe daily with a damp cloth.
- Do not use any powdered cleaners or soap pads, which may damage the finish.

**Filter change**

- Do not use cotton or any other materials. Do not wash or clean the filter. Only use filters supplied by your distributor. And do not operate without a filter.
- Change the filter every 30 days or when the filter turns gray.

**3. Changing procedure:**

- Remove the filter cover
- Replace the used filter with a new one.
- Replace the filter cover

**6. REPLACEMENT PARTS & OPTIONAL ACCESSORIES**

Replacement parts are available through your local retailer or they can be ordered through our website.

**Accessories need to be replaced**

- Nebulizer Chamber
- Adult mask
- Child mask
- Tube
- Mouth piece
- Filters

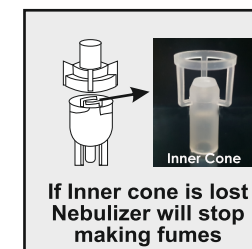

**7. TECHNICAL SPECIFICATION**

Model	OD-305
Product	Compressor Nebulizer
Power	AC 230V, 50Hz
Power consumption	68W
Medication Cup Capacity	6ml (CC) max.
Appropriate Medication Capacity	2-6ml (CC)
Storage Temperature	Room Temperature
Dimensions	17x14.5x12.5cm
Box Includes	Compressor Nebulizer with Accessory kit

5

**2. PRODUCT IDENTIFICATION**

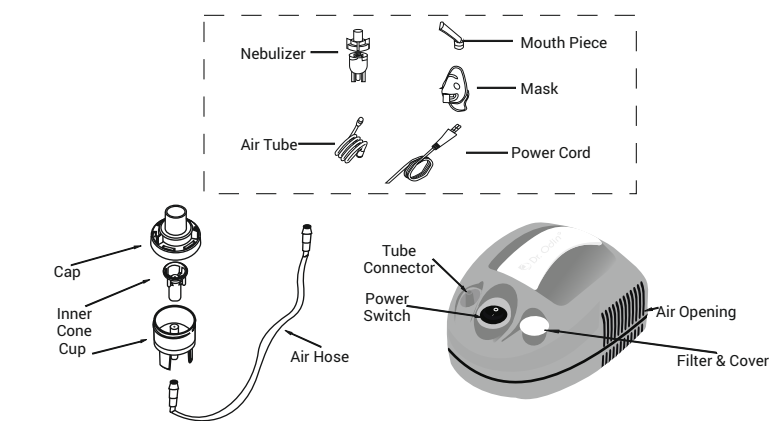

**3. IMPORTANT SAFEGUARDS**

**Note:** Read all instructions carefully before use.

The following basic precautions are needed when using an electrical product.

**Caution:** Failure to read and observe all precautions could result in personal injury or equipment damage.

**Caution:** For type, dose, and regime of medication follow the instructions of your physician or licensed healthcare practitioner.

**Product cautions**

- To avoid electrical shock: Keep the unit away from water - Do not immerse the power cord or the unit in liquid - Do not use while bathing - Do not reach for a unit that has fallen into water - immediately unplug the unit.
- Never operate the unit if it has any damaged parts (including power cord), if it has been dropped or submerged in water, promptly send it to a service center for examination and repair.
- The unit should not be used where flammable gas, oxygen or aerosol spray product are being used.
- Disconnect the unit from the electrical outlet before cleaning, filling and after each use.
- Do not use other attachment unless recommended by manufacturer.

2

**WARRANTY CARD**

Model No. .... Lot No. ....  
 Invoice No. .... Date of Purchase.....  
 Purchased by: ..... Contact No. ....  
 Address: .....  
 Dealer Name: .....  
 Dealer Sign & Stamp

**EXCEPTIONS AND LIMITATIONS**

- Breakage is not included in the warranty. Physical damages to the body of the product or sensitive internal parts including the defects caused by dropping or a heavy object falling on the unit are not included in the warranty.
- The defects caused by abuse accidents alteration, misuse, neglect, maintenance by an unauthorized person or failure to operate the unit in accordance with the instructions provided is not covered under warranty or accidental spillage of solutions causing damage to the instrument body electronic and mechanical parts(Including water damage).
- The warranty is limited to the repair or replacement of the defected parts of the units or defective workmanship on the discretion of the manufacturer if found defective due to faulty material or poor workmanship.
- The warranty should be claimed in time along with the duly filled warranty card and copy of the invoice's proof of purchase. (signed and stamped by the dealer stating the date of purchase). The manufacturer reserves the right to refuse the guarantee services if unclear information has been provided.
- The manufacturer reserves the right to make any changes in the product without prior intimations to its dealers and customers and without obligation to incorporate such changes in to the previously manufactured instruments.
- 5 Years warranty is offered for the accessories Compressor Nebulizer Kit, Mask chamber and Tube etc.
- Periodic checkups to check the functionality of the product are not included in the warranty.
- The warranty is not offered onsite. The customer has to bring/send the product to the service center (a location of choice of manufacturer within India) and has to bear the freight and risk of transportation for sending the product to our service center. And also the cost involved in case of non acceptance of warranty claim. Please call customer care no. or e-mail to support@inf-med.com or contact the distributor who sold the unit to you.

6